

SELF-PRIMING CENTRIFUGAL PUMP

MODEL **111S2-1**
UT01532

111S2-1A
UT01532-A

RS2
UT01581

INSTRUCTIONS & PARTS LIST

These instructions apply specifically to 2" Centrifugal Pump Model 111S2-1A. For general pump information and maintenance, see the **HOMELITE PUMP OPERATOR'S MANUAL** which is packed with the unit.

This pump is driven by a 4-cycle engine, and the operator should read the enclosed **ENGINE OPERATING INSTRUCTIONS** before starting the engine.

The crankcase has been drained for shipment, and must be refilled with the proper grade and weight of oil as specified in the engine instructions.

DO NOT START OR RUN THIS UNIT UNLESS THERE IS WATER IN THE PUMP.

The pump depends upon water for internal lubrication...dry running will quickly burn the seal. Fill the pump cavity with water, either at the filler plug or the inlet nipple before starting the engine.

HOSE CONNECTIONS

Hose connections to the suction inlet must be airtight to prevent loss of vacuum. Discharge hose may be used at the outlet. Keep hoses as short as possible...do not allow hose to kink or be run over by vehicles...check suction hose for broken linings which will interfere with the flow.

CAUTION

THIS UNIT IS DESIGNED TO PUMP WATER AND OTHER NON-HAZARDOUS LIQUIDS ONLY. DO NOT PUMP INFLAMMABLE MATERIAL WITH THIS UNIT.

IMPELLER & SEAL SERVICING

A drop in pumping pressure or failure to self-prime may indicate wear of the impeller or seals. To open the pump for inspection, remove four screws (parts list, key No.4) to separate the end housing from the impeller housing. It is unnecessary to remove the skid assembly as the engine end can be sprung back and blocked in position. If necessary, disassemble the pump as follows:

1. Remove the impeller by turning counterclockwise with a 13/16" wrench on the hub nut. (A sharp rap with a mallet on the wrench will free frozen threads.) Do not lose the impeller shims inside the hub.
2. Remove the soft rubber seal collar and keep track of the seal shims. Pry the seal assembly out of the backplate and **CLEAN THE RECESS THOROUGHLY.**
3. Oil the new seal assembly and slide it over the shaft into position.
4. Install the original seal shims (if any), impeller shims and washers, then the impeller. (**Figure 1**)
5. Position a straight edge across the impeller housing as in **Figure 2**. The impeller clearance should be .015 - .025". Add or subtract impeller shims to obtain the dimension.

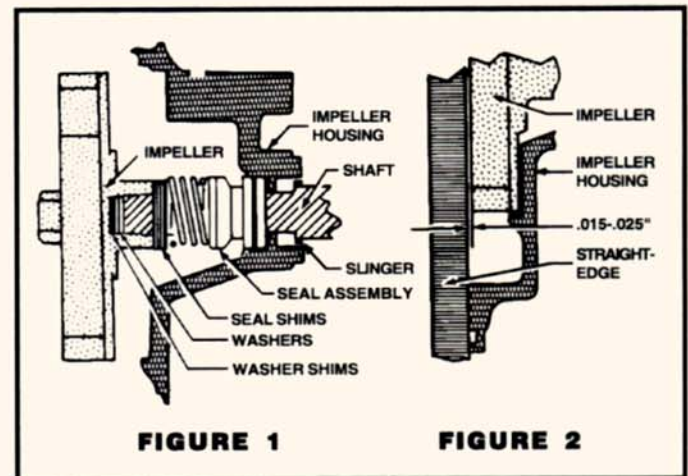

TO MAINTAIN CORRECT SEAL SPRING PRESSURE, ALWAYS ADD (OR REMOVE) SEAL SHIMS WHEN ADDING (OR REMOVING) IMPELLER SHIMS.

6. Tighten the impeller securely by tapping the wrench with a mallet, and finish reassembling the unit.

SELF-PRIMING CENTRIFUGAL PUMP MODEL 111S2-1 - UT01532 111S2-1A - UT01532-A RS2 - UT01581

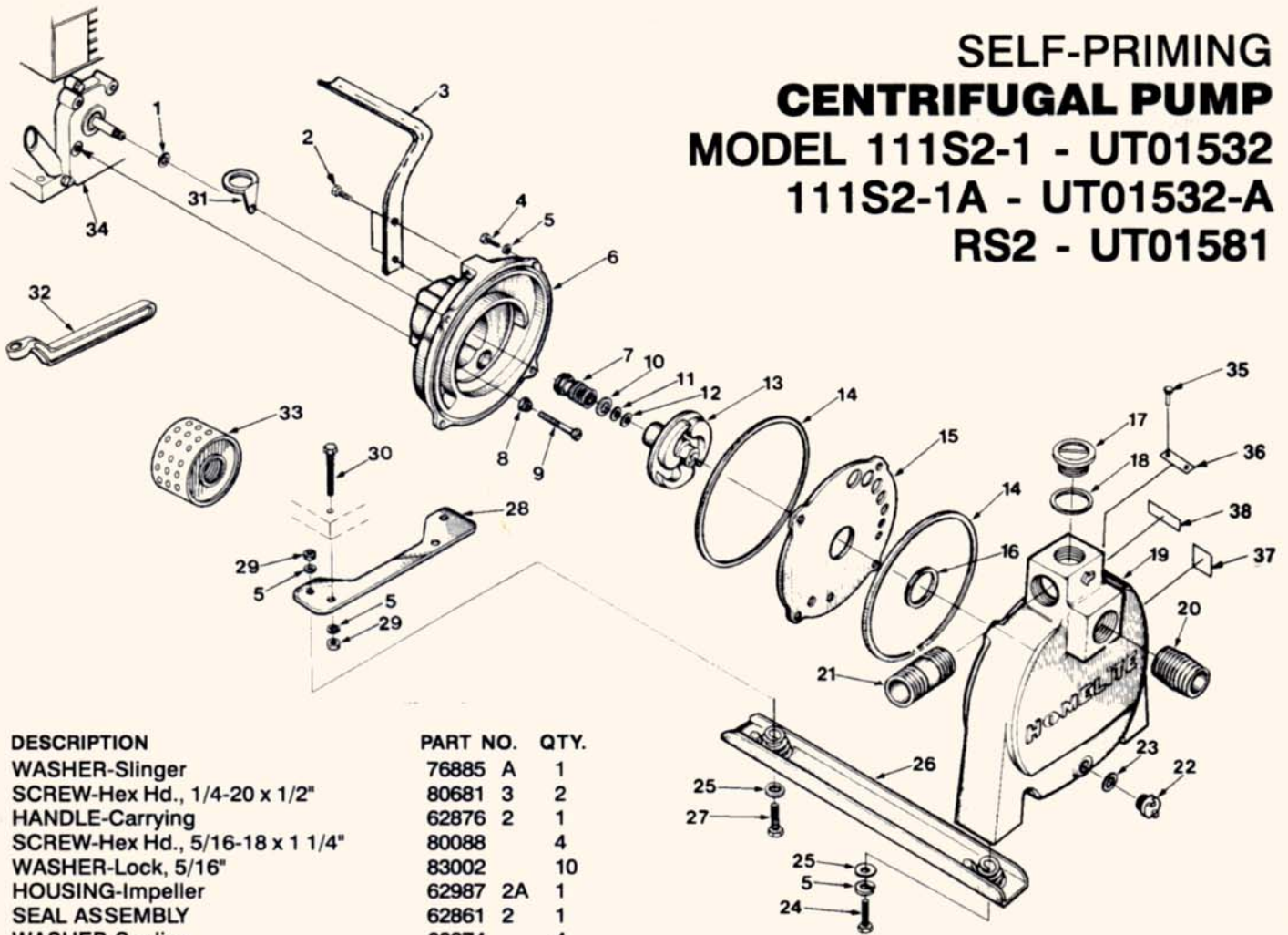

NO.	DESCRIPTION	PART NO.	QTY.
1	WASHER-Slinger	76885 A	1
2	SCREW-Hex Hd., 1/4-20 x 1/2"	80681 3	2
3	HANDLE-Carrying	62876 2	1
4	SCREW-Hex Hd., 5/16-18 x 1 1/4"	80088	4
5	WASHER-Lock, 5/16"	83002	10
6	HOUSING-Impeller	62987 2A	1
7	SEAL ASSEMBLY	62861 2	1
8	WASHER-Sealing	62874	4
9	SCREW-Hex Hd., 5/16-24 x 2 1/4"	80927	4
10	SHIM-Seal, .010"	62882 A	A/R
	SHIM-Seal, .015"	62883 A	A/R
11	WASHER-Flat 5/16"	84056	A/R
12	SHIM-Impeller, .010"	62872	A/R
	SHIM-Impeller, .015"	62873	A/R
13	IMPELLER	62988 3	1
14	GASKET-Large	54070 A	2
15	PLATE-Wear	54066 1A	1
16	GASKET-Small	54069	1
17	PLUG-Filler	A 43971	1
18	GASKET-Wing plug	18108	1
19	HOUSING-End (Aluminum)	A 47629	1
	Includes:		
20	NIPPLE-Suction, 2" NPT x 2" long	75663 1	1
21	NIPPLE-2" NPT x 3 1/2 long	54151 1	1
22	PLUG-Drain	A 43896	1
	Includes:		
23	GASKET	59910	1
24	SCREW-Hex hd., 5/16-18 x 3/4"	80083	2
25	WASHER-Flat, 5/16"	84032	4
26	SKID ASSEMBLY	A 62890	2
	Each Skid Includes:		
	SPRING-Foot	50389	2
	RIVET	85025	2
27	SCREW-Hex Hd., 5/16-18 x 1 1/4"	80088	2
28	BAR-Mounting	62888 1	1
29	NUT-Hex 5/16-18	81018	4
30	SCREW-Hex Hd., 5/16-18 x 1 1/2"	80087	2

NO.	DESCRIPTION	PART NO.	QTY.
31	HOLDER-Spanner wrench	62450 1	1
32	WRENCH-Spanner	19189 B	1
33	STRAINER-Suction, 2"	30128	1
34	ENGINE		
35	TACK-Metal	49266	4
36	PLATE-Warning	54661	1
37	DECAL-Class	48674	2
	PAINT-Red (Spray Can) (optional)	23475	

ACCESSORIES DRAIN-suction disk

48396

A/R = As Required

Item No	Torque Specs	
	In/Lbs	Nm
2	95-115	10.7-13.0
4	130-145	14.7-16.4
9	130-145	14.7-16.4
24	205-225	23.2-25.4
27	205-225	23.2-25.4
30	205-225	23.2-25.4

BRITISH THREAD ADAPTION: If 2" NPT nipples are now in end housing, install **COUPLING #54638 (2" NPT)** and then **NIPPLE #76906-1 (2" NPT to British thread)**; otherwise install #76906-1 directly in housing.

ALWAYS FURNISH MODEL AND SERIAL NUMBER WHEN ORDERING PARTS