

PRICE .10

HOMELITE TRASH PUMP

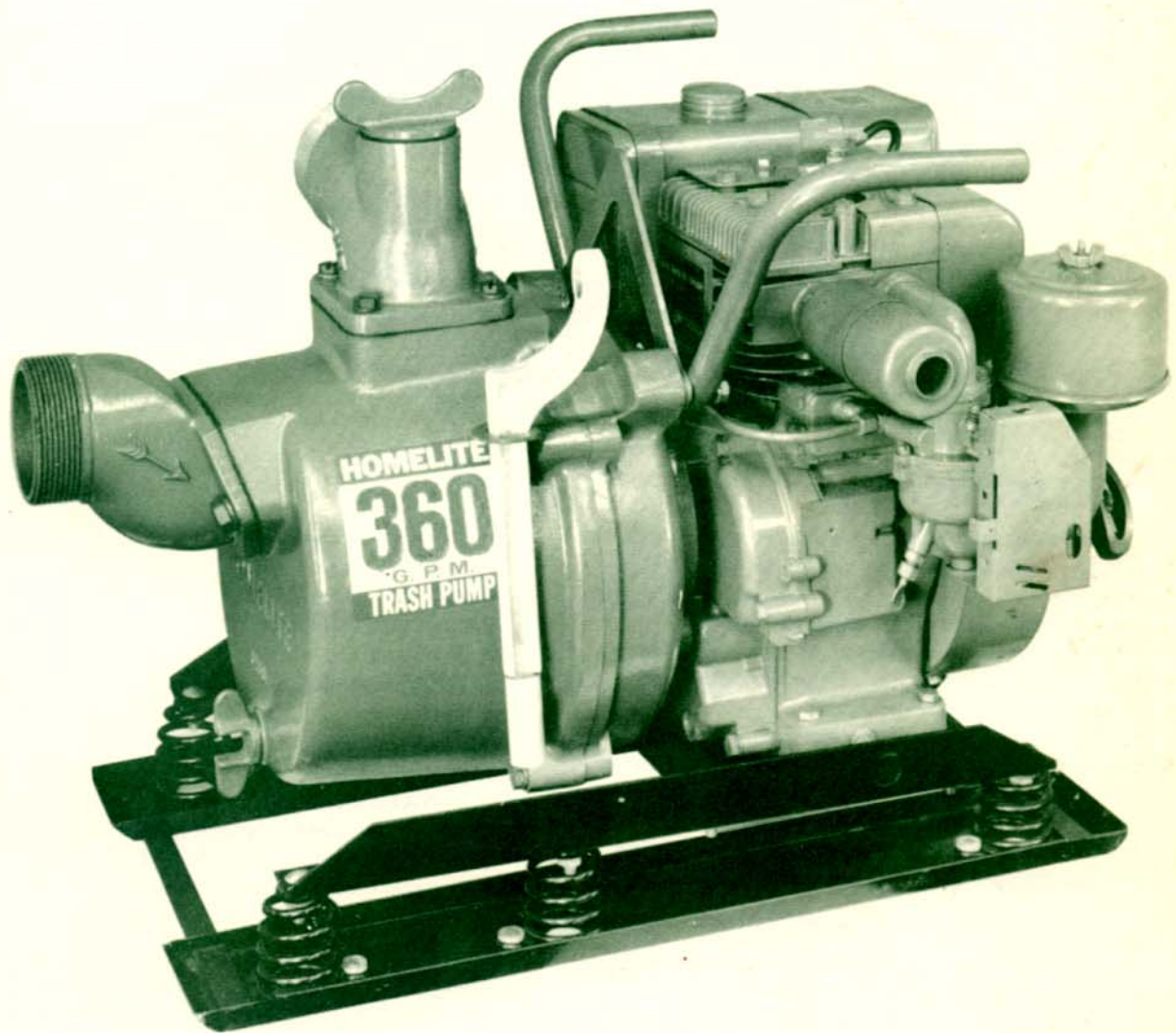

MODELS

45TP3-1 - Standard thread
45TP3-2 - British thread

45TP3-1A - Standard thread
45TP3-2A - British thread

117TP3-1 - Standard thread
117TP3-2 - British thread

CAPACITY..... 21600 G.P.H

SUCTION & DISCHARGE FITTING..... 3" STANDARD PIPE THREAD

ENGINE (45's)... BRIGGS & STRATTON, 4 CYCLE, AIR COOLED, HOMELITE PART NO. 62678

ENGINE (117)... WISCONSIN, 4 CYCLE, AIR COOLED, . . . HOMELITE PART NO. 62981

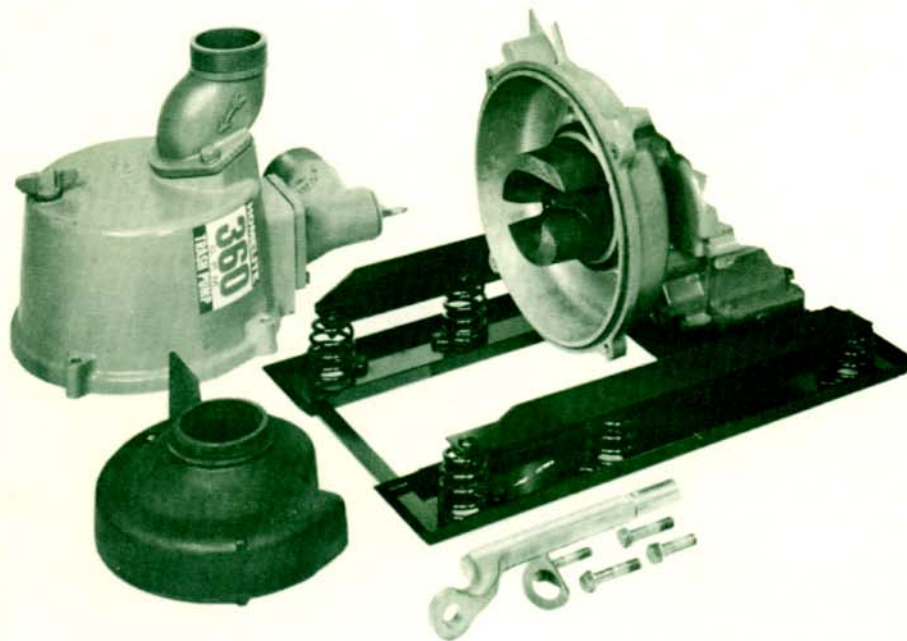

INSTRUCTIONS

We are proud that you have selected our unit, and offer these suggestions to assure you the high performance and low maintenance cost that Homelite owners have learned to expect.

This instruction sheet applies to the pumping unit and mounting parts of the Homelite self-priming, centrifugal pumps.

For the engine specifications and instructions please refer to the manufacturer's "OPERATING INSTRUCTIONS".

Your Homelite dealer from whom you purchased your pump is equipped to service your unit and furnish genuine replacement parts.

PREPARING PUMP

- a. The unit must be free to float on the shock absorbing springs of the base. Remove any blocking, used for shipping, between the base and angle irons.
- b. Connect the suction hose to the inlet fitting using a perfect gasket to insure an air-tight seal in the coupling. Use the spanner wrench furnished with the pump to tighten the coupling and obtain a good seal.

CONNECTIONS TO THE PUMP MUST BE FLEXIBLE. WHEN PIPE IS USED, CONNECT A SHORT PIECE OF HOSE BETWEEN THE PUMP AND PIPE FOR FLEXIBILITY.

- c. Hose may also be connected to the discharge fitting (located on the top of the pump body, marked "out") but does not require the extra care used for the suction connection.

- d. Attach the strainer, supplied with the unit, to the lower end of the suction hose; trash which passes through the strainer, easily passes through the inside of the pump.

NEVER RUN THE ENGINE WITHOUT WATER IN THE PUMP.

Remove the wing plug and gasket, on top of the pump, and fill the pump with water; screw plug with gasket into pump and tighten securely. The pump will now self prime and is ready for use.

TO DISASSEMBLE FOR CLEANING: use the socket end of the spanner wrench to remove the four end plate mounting screws and lockwashers. Pull the end plate and impeller housing from the pump to inspect for blockage. If the impeller must be removed tap sharply in counterclockwise direction with a leather mallet, or with a block of wood and hammer.

NEVER HAMMER DIRECTLY ON THE IMPELLER.

Inspect all gaskets for possible leakage due to splitting or deterioration. Clean all mating surfaces and any recess. Reassemble in reverse order.

See page 4 for Seal and Impeller Spacing.

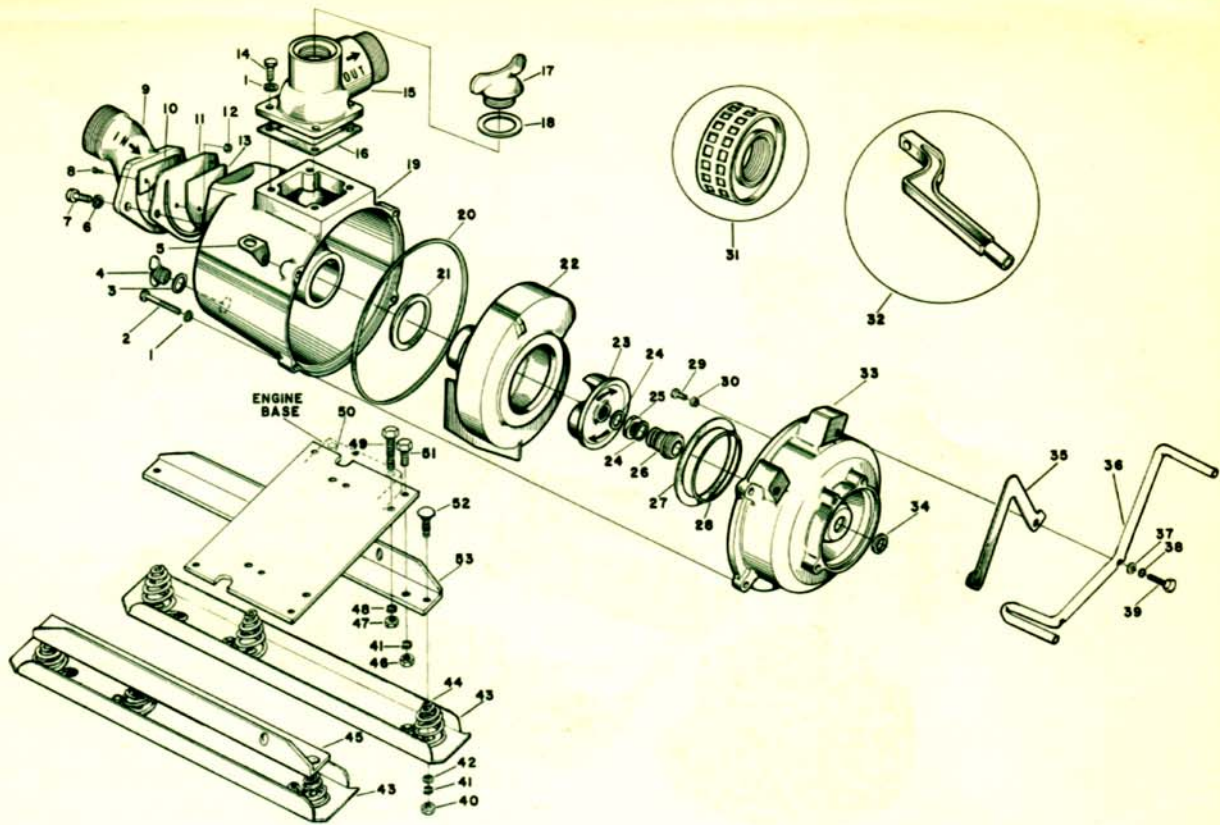

Index No.	Part No.	Description	Qty.
1	83018	WASHER-lock, 3/8	8
2	80306	SCREW-hex, 3/8-16 x 2	4
3	75986-A	GASKET	1
4	29429	PLUG-drain	1
5	62450	BRACKET-wrench holder	1
6	83020	WASHER-lock, 1/2	2
7	80272	SCREW-hex, 1/2-13 x 1 1/4	2
8	80032	SCREW-fil., 10-32 x 1/2	2
9	62657	FITTING-suction (standard)	1
	62657-1	FITTING-suction (Brit. thread)	1
10	62669	PLATE-valve (small)	1
11	62667	VALVE	1
12	81111	NUT - 10-32	2
13	62668	PLATE-valve (large)	1
14	80374-1	SCREW-hex, 3/8-16 x 1 1/8	4
15	27492-2	FITTING-discharge (standard)	1
	27492-1	FITTING-discharge (Brit. thread)	1
16	20002	GASKET-discharge fitting	1
17	18127-B	PLUG-wing	1
18	18108	GASKET	1
19	62561	PLATE-end	1
20	62367	GASKET	1
21	62363-A	GASKET	1
22	▲★	62648-B HOUSING-impeller	1
	●	62648 HOUSING-impeller	1
23	▲★	62655-B IMPELLER	1
	●	62655 IMPELLER	1
24	62675	SHIM - .010	as req'd.
	62676	SHIM - .015	as req'd.
	62677	SHIM - .032	as req'd.
25	62716	NUT-shaft (Note 1)	1
26	▲★	A-62713 SEAL ASSEMBLY	1
	●	A-62684 SEAL ASSEMBLY	1
27	▲★	62665-A GASKET	1
	●	62665 GASKET	1
28	▲★	62772 "O" RING	1

Index No.	Part No.	Description	Qty.
29	80771	SCREW-hex, 3/8-16 x 1 1/4	4
30	62666	WASHER-sealing	4
31	62659	STRAINER - 1 1/2" openings	1
	74454-A	STRAINER - 1" openings	1
32	▲	A-62680 WRENCH	1
33	▲★	62649-D PLATE - back	1
	●	62649-A PLATE - back	1
34	62688	SLINGER	1
35	▲★	62710 BRACKET - lifting	1
36	●★	62399 HANDLE	1
	▲	62399-1 HANDLE	1
37	▲★	84010-1 WASHER - flat, 3/8	2
	●	84001 WASHER - flat, 5/16	2
38	▲★	83018 WASHER - lock, 3/8	2
	●	83002 WASHER - lock, 5/16	2
39	★	80306 SCREW - hex, 3/8-16 x 2	2
	▲	80599 SCREW - hex, 3/8-16 x 1 1/4	2
	●	80087 SCREW - hex, 5/16-18 x 1 1/2	2
40	81018	NUT - 5/16-18	6
41	83003	WASHER - lock, 5/16	10
42	84001	WASHER - flat, 5/16	6
43	A-62917	SKID (Note 2)	2
		Includes	
44	25407	SPRING	3
45	62661	ANGLE - base (left)	1
46	81045	NUT - 5/16-18	4
47	●★	81046 NUT - 5/16-18	4
	▲	81043 NUT - 3/8-16	4
48	●★	83002 WASHER - lock, 5/16	4
	▲	83018 WASHER - lock, 3/8	4
49	●★	80288-1 SCREW - hex, 5/16-18 x 1 3/4	4
	▲	80096 SCREW - hex, 3/8-16 x 1 1/4	4
50	62389-A	PLATE - mounting	1
51	80695	SCREW - hex, 5/16-18 x 3/4	4
52	82003	BOLT - carriage	6
53	62662	ANGLE - base (right)	1

NOTE 1: NUT #62716 replaces narrow nut and spacer supplied in early models.

NOTE 2: TWO SKIDS #A-62917 supersede early one-piece base assembly.

Available at your HOMELITE Dealer:

#62745 FITTING- suction, 2"

#19224-B FITTING - discharge, 2"

SYMBOLS:

● denotes part used only in 45TP3-1 and 45TP3-2 models.

★ denotes part used only in 45TP3-1A and 45TP3-2A models.

▲ denotes part used only in 117TP3-1 and 117TP3-2 models.

MODEL 45TP3-1 or 45TP3-2 TRASH PUMP

Seal and Impeller Spacing

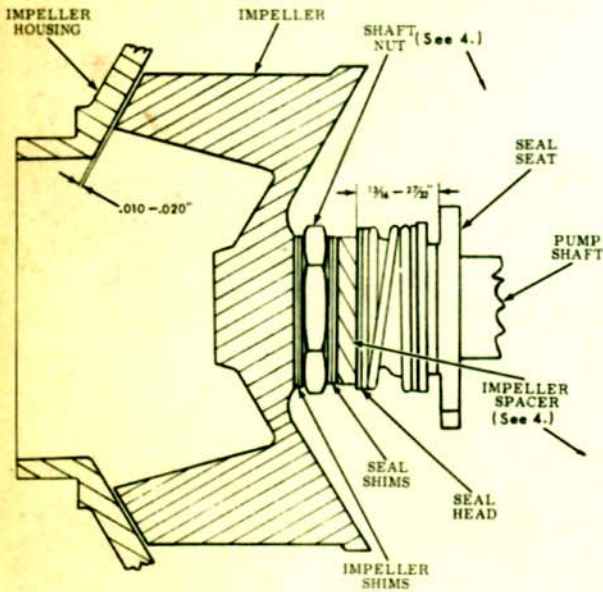

1. Install the impeller spacer and seal shims, then thread the nut onto the pump shaft as far as it will go. See 4(below).

2. Measure the distance between the seal head and the seat as shown in the drawing. Add or subtract shims as necessary to obtain a dimension of $13/16''$ to $27/32''$; this will correctly set seal spring pressure.

3. Place impeller shims against the nut, and thread the impeller onto the shaft. Add or subtract shims until the impeller just strikes the impeller housing, when the housing is in place. Remove a $.015''$ shim to set correct impeller clearance.

4. If new nut is required, replace with #62716 (thicker) NUT and discard impeller spacer. Install seal shims between new nut and seal head.

MODEL 45TP3-1A or 45TP3-2A TRASH PUMP MODEL 117TP3-1 or 117TP3-2 TRASH PUMP

Seal and Impeller Spacing

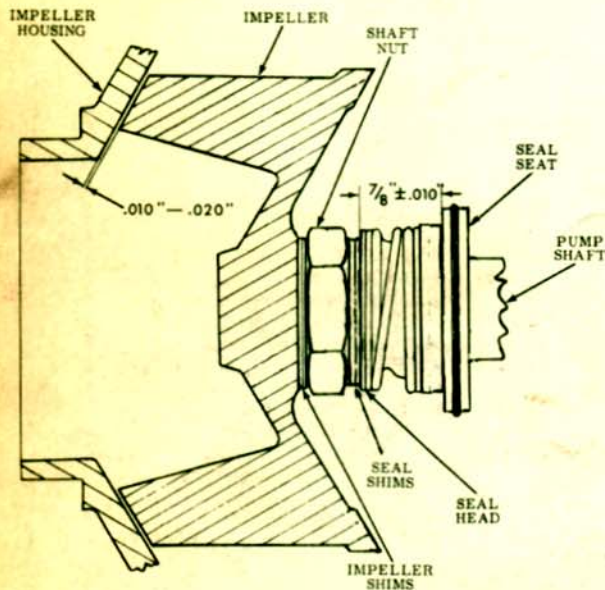

1. Install the seal shims, then thread the nut onto the pump shaft as far as it will go.

2. Measure the distance between the seal head and the seat as shown in the drawing. Add or subtract shims as necessary to obtain a dimension of $7/8'' \pm .010''$; this will correctly set seal spring pressure. Use 50 foot-pounds torque to tighten nut.

3. Place impeller shims against the nut, and thread the impeller onto the shaft. Add or subtract shims until the impeller just strikes the impeller housing, when the housing is in place. Remove a $.015''$ shim to set correct impeller clearance.

Part No. 23743
(1651165)

HOMELITE

A **Textron** DIVISION

PORT CHESTER, NEW YORK

Printed in United States of America