

HOMELITE®

SELF-PRIMING CENTRIFUGAL PUMPS

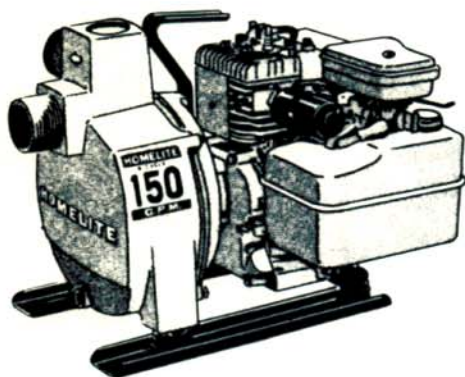

MODELS 111S2-1 & 111SU2-1 INSTRUCTIONS & PARTS LIST

INSTRUCTIONS

These instructions apply specifically to 2" Centrifugal Pump Models 111S2-1 and 111SU2-1. For general pump information and maintenance, see the HOMELITE PUMP OPERATOR'S MANUAL which is packed with the unit.

This pump is driven by a Briggs & Stratton 4-cycle engine, and the operator should read the enclosed ENGINE OPERATING INSTRUCTIONS before starting the engine.

The crankcase has been drained for shipment, and must be refilled with the proper grade and weight of oil as specified in the engine instructions.

DO NOT START OR RUN THIS UNIT UNLESS THERE IS WATER IN THE PUMP.

The pump depends upon water for internal lubrication. . . dry running will quickly burn the seal. Fill the pump cavity with water, either at the filler plug or the inlet nipple before starting the engine.

HOSE CONNECTIONS

Hose connections to the suction inlet must be airtight to prevent loss of vacuum. Discharge hose may be used at the outlet. Keep hoses as short as possible . . . do not allow hose to kink or be run over by vehicles . . . check suction hose for broken linings which will interfere with the flow. CAUTION. . . THIS UNIT IS DESIGNED TO PUMP WATER AND OTHER NON-HAZARDOUS LIQUIDS ONLY. DO NOT PUMP INFLAMMABLE MATERIAL WITH THIS UNIT.

IMPELLER & SEAL SERVICING

A drop in pumping pressure or failure to self-prime may indicate wear of the impeller or seals. To open the pump for inspection, remove four screws (parts list, key #4) to separate the end housing from the impeller housing. On Model 111S2-1 it is unnecessary to remove the skid assembly as the engine end can be sprung back and blocked in position. If necessary, disassemble the pump as follows:

1. Remove the impeller by turning counterclockwise

with a 13/16" wrench on the hub nut. (A sharp rap with a mallet on the wrench will free frozen threads.) Do not lose the impeller shims inside the hub.

2. Remove the soft rubber seal collar and keep track of the seal shims. Pry the seal assembly out of the back-plate and CLEAN THE RECESS THOROUGHLY.

3. Oil the new seal assembly and slide it over the shaft into position.

4. Install the original seal shims (if any), impeller shims and washers, then the impeller. (Figure 1)

5. Position a straight edge across the impeller housing as in Figure 2. The impeller clearance should be .015-.025." Add or subtract impeller shims to obtain the dimension.

TO MAINTAIN CORRECT SEAL SPRING PRESSURE, ALWAYS ADD (OR REMOVE) SEAL SHIMS WHEN ADDING (OR REMOVING) IMPELLER SHIMS.

6. Tighten the impeller securely by tapping the wrench with a mallet, and finish reassembling the unit.

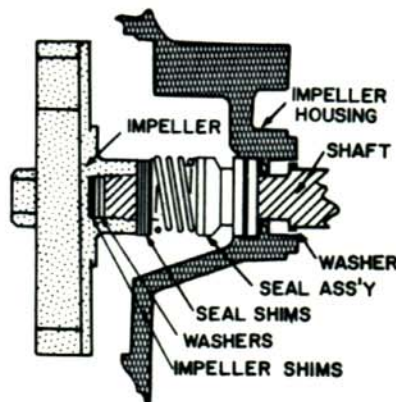

FIGURE 1

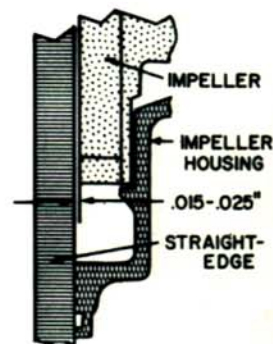

FIGURE 2

HOMELITE®

• lextron
DIVISION

PORT CHESTER, N.Y. U.S.A.

111S2-1 111SU2-1

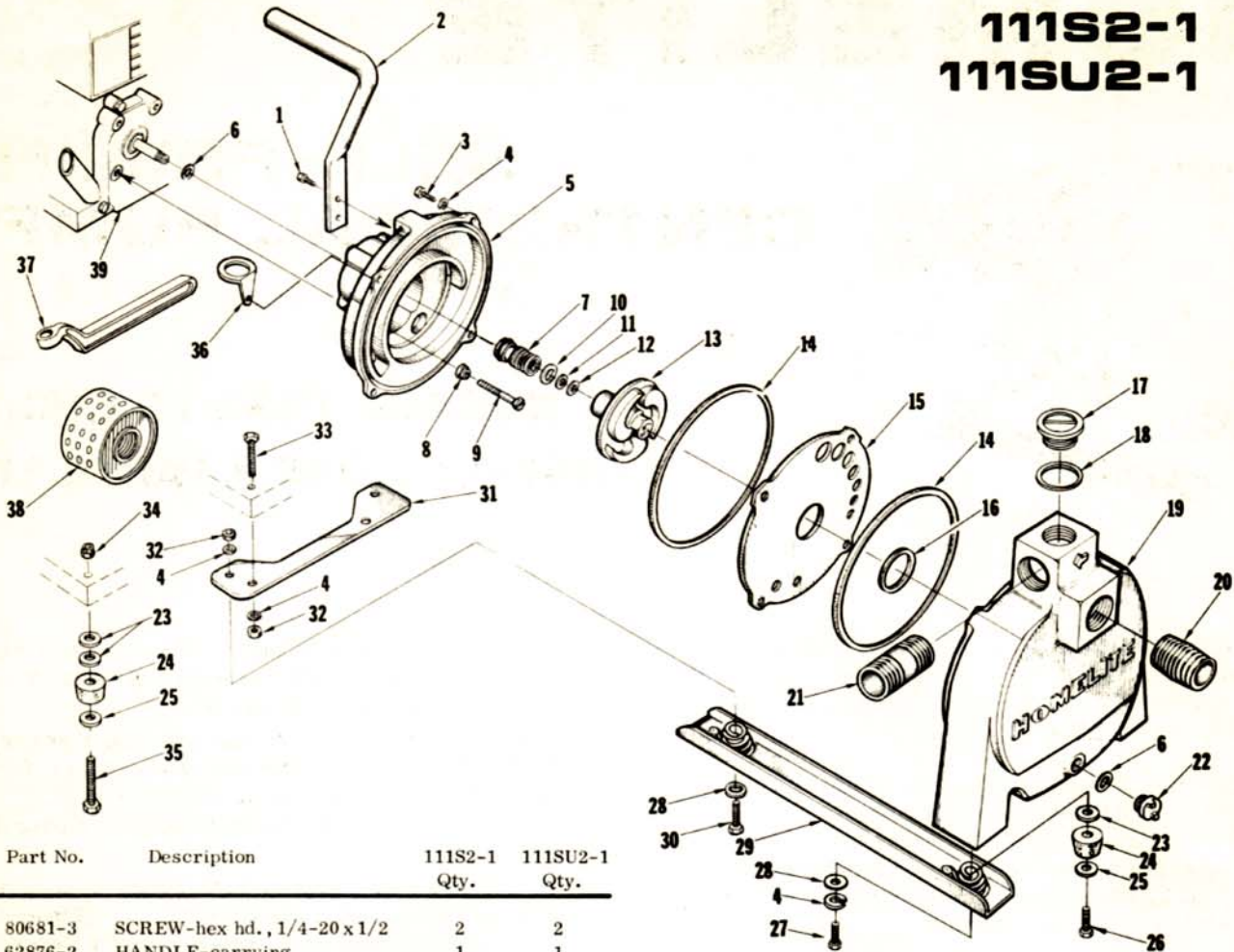

Key	Part No.	Description	111S2-1 Qty.	111SU2-1 Qty.
1	80681-3	SCREW-hex hd., 1/4-20 x 1/2	2	2
2	62876-2	HANDLE-carrying	1	1
3	80086	SCREW-hex hd., 5/16-18 x 1-1/8	4	4
4	83002	WASHER-lock, 5/16	10	4
5	62987-2	HOUSING-impeller	1	1
6	76885-A	WASHER-(slinger & drain plug)	2	2
* 7	A-62861-2	SEAL ASSEMBLY	1	1
8	62874	WASHER-sealing	4	4
9	80927	SCREW-hex hd., 5/16-24 x 2-1/4	4	4
10	‡ 62882	SHIM-seal, .010"	as req'd	as req'd
	‡ 62883	SHIM-seal, .015"	as req'd	as req'd
11	84056	WASHER-spacer	2	2
12	‡ 62872	SHIM-impeller, .010"	as req'd	as req'd
	‡ 62873	SHIM-impeller, .015"	as req'd	as req'd
13	62988-3	IMPELLER	1	1
14	54070	GASKET-large	2	2
15	54066-2	PLATE-wear	1	1
16	54069	GASKET-small	1	1
17	A-54152	PLUG-filler	1	1
		Includes:		
18	54196	GASKET-filler plug	1	1
19	62989-5	HOUSING-end (aluminum)	1	†
19	62989-7	HOUSING-end (cast iron)	†	1
20	75663-1	NIPPLE-suction, 2" NPT x 2" long	1	†
21	54151-1	NIPPLE-2" NPT x 3-1/2 long	1	†
* 22	54858-6	PLUG-drain	1	1
23	84058	WASHER-flat, 5/16 x 3/16 thick		6
24	61966	BUMPER		4
25	84065-1	WASHER-flat, 5/16		4

Key	Part No.	Description	111S2-1 Qty.	111SU2-1 Qty.
26	80084-1	SCREW-hex hd., 5/16-18 x 7/8		2
27	80083-1	SCREW-hex hd., 5/16-18 x 3/4	2	
28	84032	WASHER-flat, 5/16	4	
29	A-62890	SKID ASSEMBLY	2	
		Each Skid Includes:		
	50389	SPRING-foot	2	
	85025	RIVET	2	
30	80085-1	SCREW-hex hd., 5/16-18 x 1	2	
31	62888-1	BAR-mounting	1	
32	81018-1	NUT-hex, 5/16	4	
33	80087	SCREW-hex hd., 5/16-18 x 1-1/2	2	
34	81096	NUT-lock, 5/16		2
35	80288-1	SCREW-hex hd., 5/16-18 x 1-3/4		2
36	62450-1	HOLDER-spanner wrench	1	†
37	19189-B	WRENCH-spanner	1	†
38	30128	STRAINER-suction, 2"	1	1
	23475	PAINT-red (Spray Can)	†	†
39	54150	ENGINE-Briggs & Stratton	1	†
*	54153	ENGINE-Briggs & Stratton	†	1

* Indicates new parts

‡ See shimming instructions on reverse side

† Optional equipment on this model

BRITISH THREAD ADAPTION: If 2" NPT nipples are now in end housing, install COUPLING #54638 (2" NPT) and then NIPPLE #76906-1 (2" NPT to British thread); otherwise install #76906-1 directly in housing.