

HOMELITE®

TRASH PUMPS:

120TP3-1

117TP3-1

45TP3-1

SPECIAL INSTRUCTIONS

These instructions are for the Homelite 120TP3, 117TP3 and 45TP3 Trash Pumps. For general pump instructions, maintenance and trouble-shooting procedures, the operator should familiarize himself with the booklet HOMELITE PUMPS which is packed with the unit. For engine operation and maintenance see the Briggs & Stratton engine booklet. Before operating the pump, we suggest that the operator read both of these manuals thoroughly.

NEVER START OR RUN THIS UNIT UNLESS THERE IS WATER IN THE PUMP

IMPELLER & SEAL SERVICE

A loss of pumping pressure indicates wear of the impeller, seal or gaskets. To disassemble the unit for inspection and/or cleaning, remove the four screws holding the impeller housing to the adapter, remove the end housing and the impeller housing.

Examine all gaskets for wear or damage that would cause leaks. Replace any faulty gaskets.

Unless the impeller is damaged or completely worn out, pumping efficiency can usually be restored by adding spacer shims. See spacing instructions below.

If it is necessary to remove the impeller, use a leather mallet or a block of wood and a hammer and tap sharply in a counterclockwise direction. To avoid cracking the casting, NEVER USE A HAMMER DIRECTLY ON THE IMPELLER.

To replace a damaged seal assembly, remove the impeller, shims and shaft nut. The seal assembly can be pried out of the backplate with a small screwdriver and discarded. When installing a new seal, oil the backplate recess and seal assembly lightly and slide the assembly into position. Follow the spacing instructions outlined below.

CAUTION.... THIS UNIT IS DESIGNED TO PUMP WATER AND OTHER NON-HAZARDOUS LIQUIDS ONLY. NEVER PUMP INFLAMMABLE MATERIAL WITH THIS UNIT.

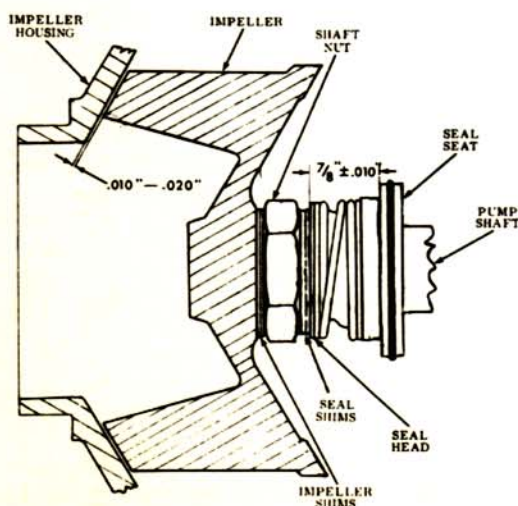

SEAL AND IMPELLER SPACING INSTRUCTIONS

1. Install the seal shims and thread the nut onto the shaft as far as it will go.
2. Measure the distance between the seal head and seat as shown. Add or subtract shims as necessary to obtain a dimension of $7/8'' (\pm .010'')$, to correctly set seal spring pressure. Tighten the nut to 50# torque.
3. Place impeller shims against the nut and thread on the impeller. Add or subtract shims until the impeller just strikes the impeller housing when the housing is held in place. Remove one .015" shim to set correct impeller clearance. Complete reassembly of the unit.

TURN THE ENGINE OVER BY HAND AND LISTEN FOR SCRAPING NOISES BEFORE RUNNING THE UNIT.

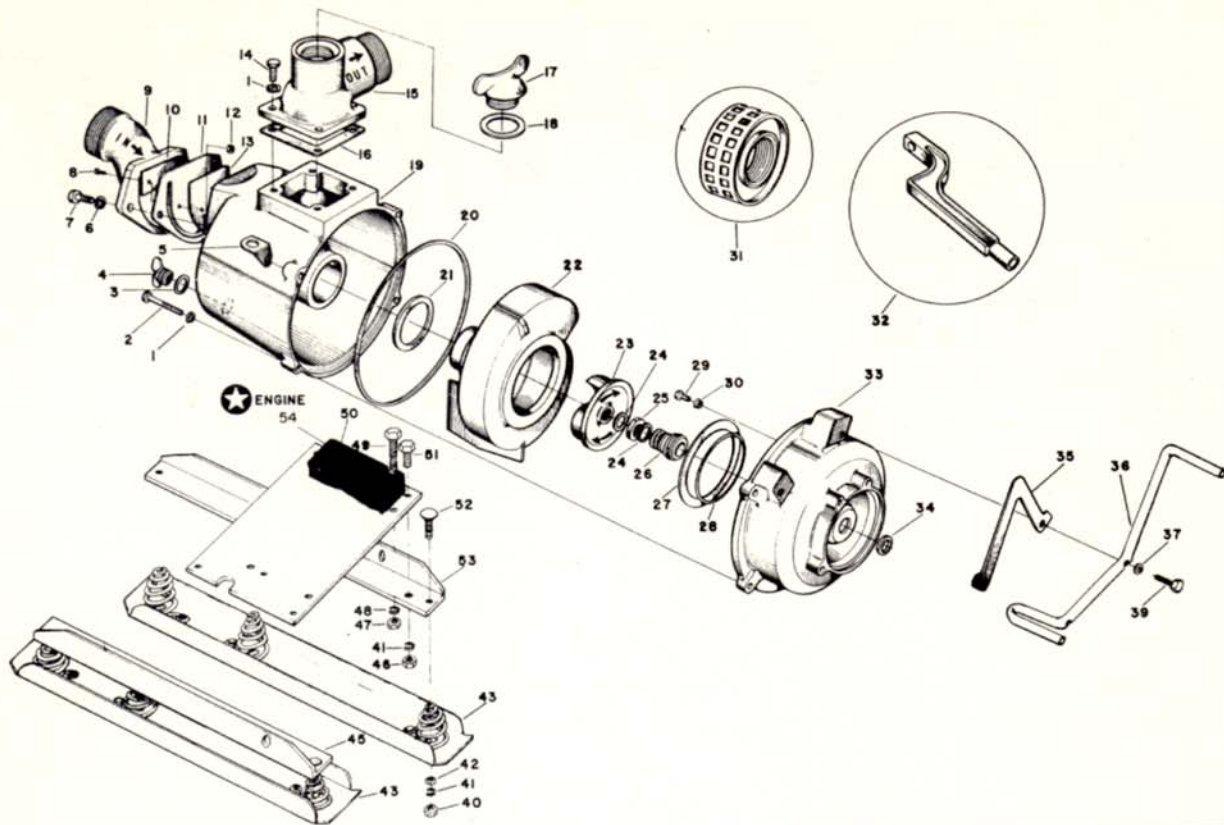

Index No.	Part No.	Description	Qty.
1	83018	WASHER, lock (3/8")	10
2	●80306	SCREW, hex hd. (3/8 - 16 x 2")	6
2	★80306	SCREW, hex. hd. (3/8-16 x 2")	4
3	75896-A	GASKET, drain plug	1
† 4	29429-3	PLUG, drain	1
† 5	62450-1	HOLDER, spanner wrench	1
6	83020	WASHER, lock (1/2")	2
7	80272	SCREW, hex hd. (1/2 - 13 x 1 -1/4")	2
8	80032	SCREW, brass fil. hd. (10-32 x 1/2")	2
† 9	62657-3	FITTING, suction (standard thread)	1
10	62669	PLATE, valve (small)	1
11	62667	VALVE	1
12	81111	NUT (10 - 32)	2
13	62668	PLATE, valve (large)	1
14	80374-1	SCREW, hex hd. (3/8 - 16 x 1 -1/8")	4
† 15	27492-3	FITTING, discharge (standard)	1
16	20002	GASKETS, discharge fitting	1
† 17	18127-2	PLUG, wing	1
18	18108	GASKET, filler plug	1
† 19	62561-2	HOUSING, end	1
20	62367	GASKET, large	1
21	62363-A	GASKET, small	1
† 22	62648-2	HOUSING, impeller	1
† 23	62655-2	IMPELLER	1
24	62675	SHIM - .010"	as req.
	62676	SHIM - .015"	as req.
	62677	SHIM - .032"	as req.
25	62716	NUT, impeller	1
26	A-62713	SEAL ASSEMBLY	1
		includes:	
	62715	HEAD, seal	1
27	62665-A	GASKET, impeller housing	1
28	62772	"O" RING	1

Index No.	Part No.	Description	Qty.
29	80771	SCREW, hex hd. (3/8 - 16 x 1 -1/4")	4
30	62666	WASHER, sealing	4
31	●74454-A	STRAINER (1" openings)	1
32	●A-62680	WRENCH, spanner	1
† 33	62649-2	PLATE, back	1
34	62688	SLINGER	1
† 35	62710-1	BRACKET, lifting	1
† 36	62399-3	HANDLE, carrying	1
37	●84010-1	WASHER, flat (3/8")	2
39	★80098	SCREW, hex. hd. (3/8-16 x 1-3/4")	2
40	81018-1	NUT, (5/16 -18)	6
41	83003	WASHER, lock (5/16")	10
42	84046	WASHER, flat (5/16")	6
43	A-62917	SKID	2
		includes: (each)	
	25407	SPRING	3
	85025	RIVET	3
45	62661-1	ANGLE, base (left)	1
46	●81162	NUT, 5/16 - 18	8
48	●83002	WASHER, lock (5/16")	4
49	●80288-1	SCREW, hex hd. (5/16 - 18 x 1 -3/4")	4
46	★81162	NUT, (5/16-18)	4
47	★81043	NUT, (3/8-16)	4
48	★83018	WASHER, lock (3/8")	4
49	★80096	SCREW, hex. hd. (3/8-16 x 1-1/4")	4
† 50	62389-1	PLATE, engine mounting	1
51	80695	SCREW, hex hd. (5/16 - 18 x 3/4")	4
52	82003	BOLT, carriage	6
† 53	62662-1	ANGLE, base (right)	1
★54	●54848	ENGINE, Briggs & Stratton	1
54	★62981	ENGINE, Wisconsin	1

ACCESSORIES AND OPTIONS AVAILABLE AT YOUR HOMELITE DEALER.

†62657-5	FITTING, Suction (British Thread)	†19224-2	FITTING, Discharge - 2"
†27492-5	FITTING, Discharge (British Thread)	74454-A	STRAINER, 1" openings
†62745-2	FITTING, Suction - 2"	62659	STRAINER, 1-1/2" openings
	A-62713-1	SEAL, liquid fertilizer	

★NOTE: ENGINE 54848 WILL REPLACE ENGINE 62678 ON 45TP3

● INDICATES PARTS USED IN 120TP3 ONLY

★ INDICATES PARTS USED IN 117TP3 ONLY

† INDICATES PART NUMBER CHANGE - NO PHYSICAL CHANGE

* INDICATES NEW PARTS