

HOMELITE®

CENTRIFUGAL PUMP

model 120S3-1

INSTRUCTIONS & PARTS LIST

INSTRUCTIONS

These instructions apply specifically to the Homelite 120-S3-1 3" Centrifugal Pump. For general pumping information on operation and maintenance, please see the Homelite Pump Operators' Manual packed with the unit.

This pump is driven by a 4-cycle Briggs & Stratton engine. Read the engine operators' manual before starting the engine.

The engine crankcase has been drained for shipment: Be certain to fill the crankcase with the grade and type of oil specified in the manual.

PREPARATION

Water in the pump is necessary for seal lubrication. Fill the unit with water before starting the engine.

DO NOT RUN THE PUMP WITHOUT WATER IN IT.

PRIMING

The 120 S3-1 is self priming to suction lifts of 28 feet. Priming time is greatly affected by the suction lift; keep the height from the water surface to the pump as low as possible to reduce priming time.

HOSE CONNECTIONS

Make certain that the suction hose connection is air tight. Air leakage at the inlet will prevent the pump from priming and reduce pumping efficiency. If pipe is used, connect a short piece of flexible hose between the pipe and the pump.

Always use the strainer on the suction hose to prevent large solids from being drawn into the pump.

Hose may be connected to the discharge outlet. This connection need not be air tight. When laying suction and discharge lines, avoid kinks and do not allow vehicles to run over the hose.

IMPELLER & SEAL SERVICE

Separate the end housing from the impeller housing. Re-

move the wear plate, noting its correct position. Use a 13/16" wrench to turn the impeller counter clockwise; A sharp rap with a mallet on the wrench will free frozen threads.

To remove the seal, pry off the rubber collar and pull out the head. Use a small screwdriver to remove the seal seat. Clean the seal surface thoroughly and lubricate the new assembly before installation. (See Figure 1).

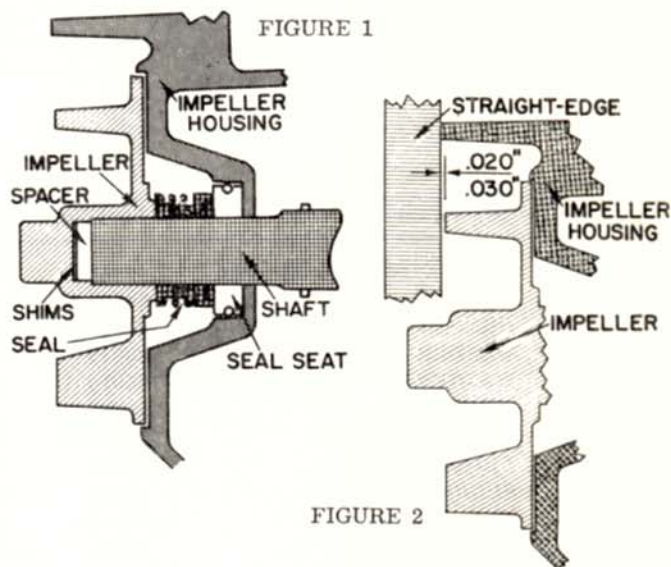

When reinstalling the impeller, use shims to maintain a .020"-.030" clearance between the impeller vanes and the wearplate. A straightedge can be used to check clearance as shown in Figure 2.

Reassemble the pump and turn the engine over by hand. Listen for scraping noises which indicate insufficient impeller-to-wearplate clearance, and adjust if necessary.

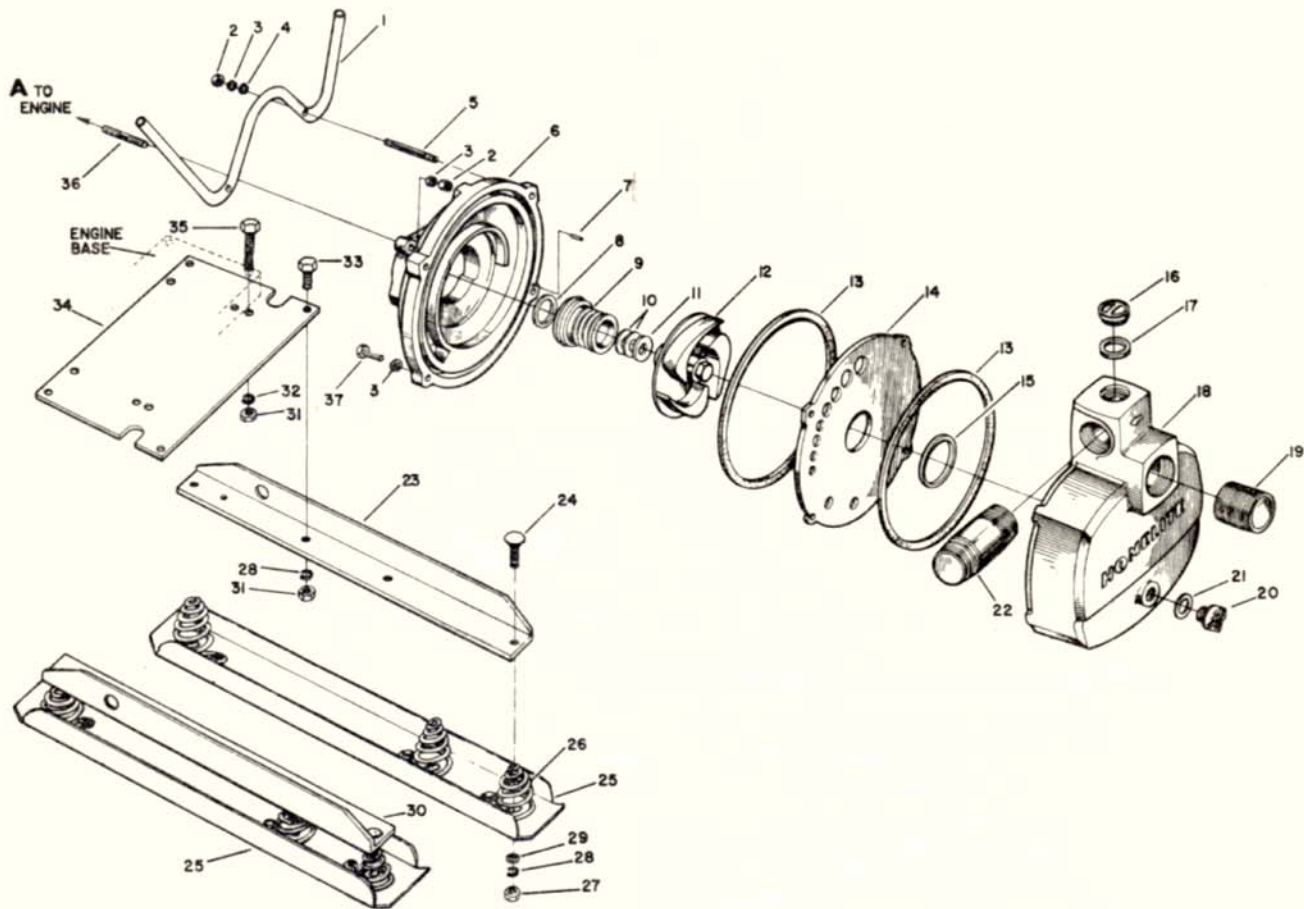

No.	Description	Part No.	Qty.
A	ENGINE-Briggs & Stratton	54848	1
1	HANDLE	54351-1	1
2	NUT-3/8-16	81043	6
3	WASHER-lock, 3/8	83018	8
4	WASHER-flat, 3/8	84010-1	2
5	STUD-	54361	2
6	HOUSING-impeller	† 62980-2	1
7	PIN-coiled spring	67908	1
8	SLINGER	62688	1
9	SEAL ASSEMBLY	A-62713-1	1
10	SHIM-seal (.010)	75909	as req'd
	SHIM-seal (.015)	75910	as req'd
11	SPACER	62408	1
12	IMPELLER	† 54067-3	1
13	GASKET-large	62927	2
14	PLATE-wear	62926-1	1
15	GASKET-small	62928	1
16	PLUG-filler	A-54152	1
17	Includes: GASKET	54196	1
18	HOUSING-end	62922-2	1
19	NIPPLE-suction	74343-1	1
20	PLUG-drain	54858-6	1
21	WASHER-gasket	76885-A	1

No.	Description	Part No.	Qty.
22	FITTING-pipe (discharge)	54289-1	1
23	ANGLE-base (left)	62661-1	1
24	SCREW-hex hd., 5/16-18 x 1	80085-1	6
25	SKID ASSEMBLY	A-62917	2
	Includes: (each assembly)		
26	SPRING	25407	3
	RIVET	85025	3
27	NUT-hex, 5/16-18	81018-1	6
28	WASHER-lock, 5/16	83003	10
29	WASHER-flat, 5/16	84046	6
30	ANGLE-base (right)	62662-1	1
31	NUT-hex, 5/16-18	81162	8
32	WASHER-lock	83002	4
33	SCREW-hex, 5/16-18 x 3/4	80695	4
34	PLATE-engine mounting	62389-1	1
35	SCREW-hex, 5/16-18 x 1 3/4	80288-1	4
36	STUD	30679	4
37	SCREW-3/8-16 x 1 1/2	80097-3	2
	HOLDER-spanner wrench	62450-1	1

ACCESSORIES

STRAINER	30129	1
WRENCH-spanner	20024-B	1
SEAL-(for solvents)	A-62713-2	1

† Indicates Part Number Change - No Physical Change