

HOMELITE®

DIAPHRAGM PUMP



model 111DP3-1 INSTRUCTIONS & PARTS LIST

INSTRUCTIONS

These instructions apply specifically to the Model 111DP3-1 4-cycle Diaphragm Pump. For general pump information and operations, please refer to the Homelite Pump Operators Manual, part number 24003, which is packed with each unit.

The 111DP3-1 is driven by a Briggs and Stratton 4-cycle engine. Read the enclosed engine operating manual before starting the unit.

The engine has been drained for shipment; be certain to fill the crankcase to the indicated level with the proper grade of oil specified in the engine manual.

LUBRICATION:

The pump gear case is drained for shipment, and must be filled to the level of the filler plug with SAE 90 gear oil (Homelite 55291-B) before operation. Check the oil at weekly intervals to maintain this level.

The pump rod journal bearing should be greased at monthly intervals. Apply bearing grease at the journal fitting until fresh grease oozes from the journal.

PRIMING

The 111DP3-1 is self priming to lifts of 15 feet. To prime above 15 feet, remove the stand-pipe plug and pour in approximately one gallon of water: Retighten the plug securely.

OPERATING HINTS:

Always use the strainer to prevent debris from clogging the valves.

Inlet (suction) connections to the pump must be air tight to prevent loss of vacuum.

Pump connections must be flexible; if a pipe is used, connect a short piece of flexible hose between the pipe and the pump.

The vertical discharge limit of this pump is 25 feet. Pumping to heights greater than 25 feet above the unit is not practical.

SAFETY PRECAUTIONS

This pump is designed for pumping water. It may be used for pumping other non-hazardous liquids, but under no circumstances should it be used for pumping hazardous material.

Do not fill the fuel tank while the engine is running, as this may cause a fire. Be sure to remove any spilled fuel before starting the engine.

Do not touch the hot muffler.

Do not operate pump without pump rod guard in place.

111DP3-1

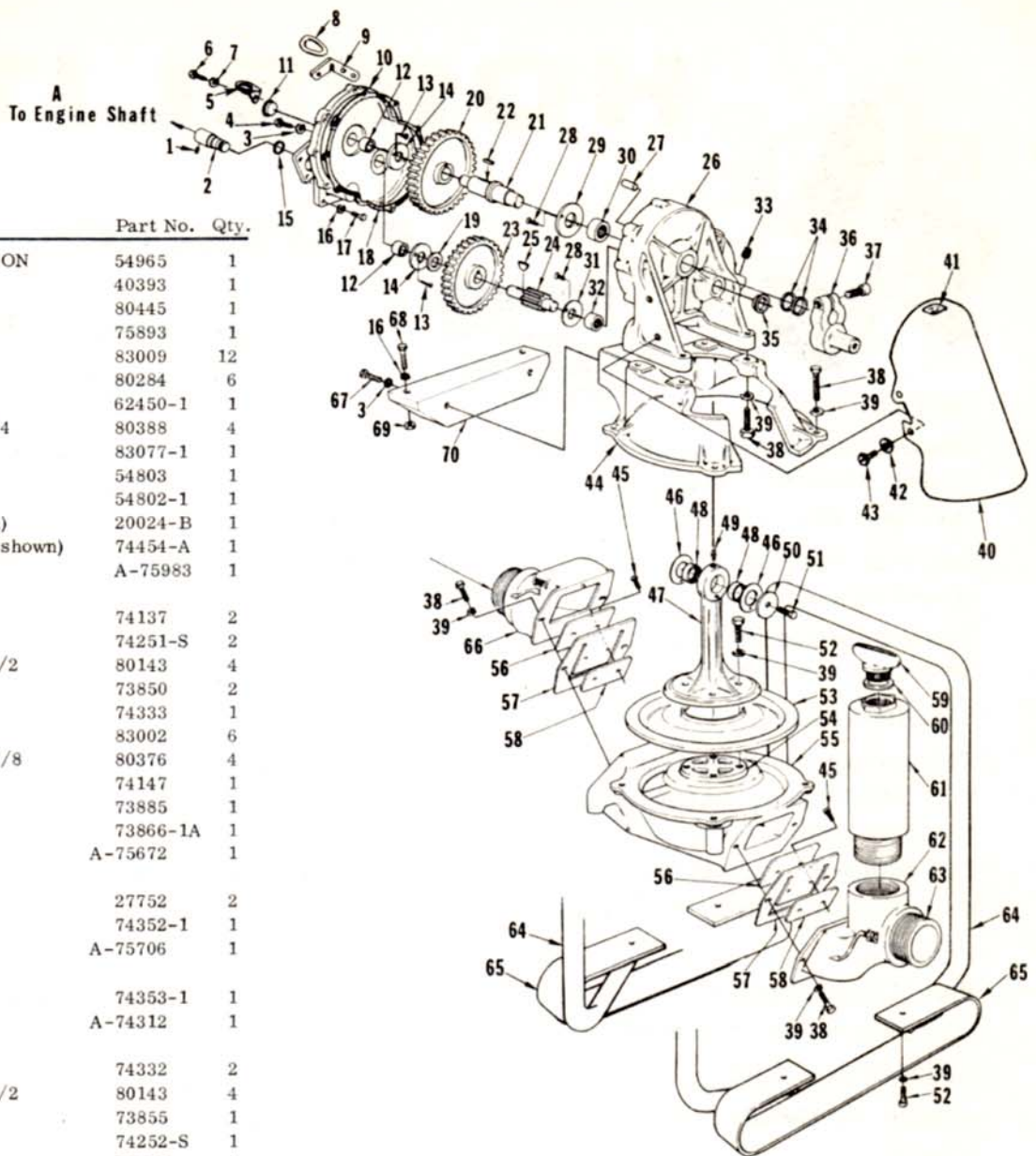

No.	Description	Part No.	Qty.
A	ENGINE, BRIGGS & STRATTON	54965	1
	KEY (not shown)	40393	1
1	SCREW-set, 1/4-20 x 1/2	80445	1
2	SHAFT-pinion	75893	1
3	WASHER-lock, 1/4	83009	12
4	SCREW-hex hd., 1/4-20 x 1	80284	6
5	WRENCH HOLDER	62450-1	1
6	SCREW-hex hd., 1/4-20 x 1/4	80388	4
7	WASHER-lock	83077-1	1
8	LINK-lifting	54803	1
9	BRACKET-lifting	54802-1	1
	WRENCH-spanner (not shown)	20024-B	1
	STRAINER-suction hose (not shown)	74454-A	1
10	GEAR CASE COVER	A-75983	1
	Includes:		
11	CAP-bearing	74137	2
12	BEARING-needle	74251-S	2
13	SCREW-flat hd., 8-32 x 1/2	80143	4
14	WASHER-thrust	73850	2
15	SEA L-extension shaft	74333	1
16	WASHER-lock, 5/16	83002	6
17	SCREW-hex hd., 5/16-24 x 7/8	80376	4
18	GASKET-gear case	74147	1
19	SPACER	73885	1
20	GEAR-pump	73866-1A	1
21	SHAFT-gear	A-75672	1
	Includes:		
22	KEY	27752	2
23	GEAR-intermediate	74352-1	1
24	GEAR	A-75706	1
	Includes:		
25	KEY	74353-1	1
26	GEAR CASE ASSEMBLY	A-74312	1
	Includes:		
27	PIN-dowel	74332	2
28	SCREW-flat hd., 8-32 x 1/2	80143	4
29	WASHER-thrust	73855	1
30	BEARING-needle	74252-S	1
31	WASHER-thrust	73850	1
32	BEARING-needle	74251-S	1
33	PLUG-pipe	50749	1
34	SEA L-garlock	74333	2
35	CAP-bearing	74137	1
36	CRANK	73858-3	1
37	SCREW-socket hd., 1/2-13 x 1-1/2	80423	1
38	SCREW-hex hd., 1/2-13 x 1-3/4	80627	12
39	WASHER-lock, 1/2	83020	20
*40	GUARD-pump rod	A-51135	1
	Includes:		
41	DECA L-grease fitting	24581	1
42	WASHER-flat	84004-1	4
43	SCREW-hex hd., 12-24 x 3/8	80837	4
44	BODY-pump (upper)	74118-4	1
45	SCREW-fil hd., 10-32 x 1/2	80393	4
46	WASHER-thrust	73856	2
47	PUMP ROD ASSEMBLY	A-74339	1
	Includes:		
48	BEARING-needle	74121-S	2
49	FITTING-grease	32409	1
	PIN-coiled spring (not shown)	76982	1
50	WASHER	73857	1
51	SCREW-hex hd., 3/8-16 x 3/4	80171	1
52	SCREW-hex hd., 1/2-13 x 1-1/4	80272	8
53	DIAPHRAGM	74351	1
54	PLATE-diaphragm	73706-1	1
55	PUMP BODY ASSEMBLY	A-74313	1
	Includes: PIN-roll (not shown)	54890-1	1

No.	Description	Part No.	Qty.
56	VALVE-plate	74156	2
57	VALVE-flapper	74154	2
58	WEIGHT-valve	74155-1	2
59	PLUG-wing	54551-3	1
60	GASKET-plug	18108	1
61	STANDPIPE-3"	74344-2	1
62	SUCTION FITTING	A-74348	1
	Includes:		
	PIN-roll (not shown)	54890-1	1
63	NIPPLE-3"	74343-1	2
64	HANDLE-carrying	54192-1A	2
65	SPRING-foot	73731-1	2
66	DISCHARGE FITTING	73874-2	1
67	SCREW-hex hd., 1/4-20 x 3/4	80218-1	2
68	SCREW-hex hd., 5/16-18 x 1-1/2	80087	2
69	NUT-hex, 5/16-18	81162	2
70	BRACKET-engine to pump	75981-1	1

Accessories

COUPLING-hose, 3"	54639	(2)
FITTING-pipe 3" (NPT to British)	74676-1	(2)
FITTING-pump discharge, 2"	A-75662	
FITTING-pump suction, 2"	A-75661	
FOOT VALVE	A-26799	
STRAINER w/FOOT VALVE-use for solids	74354-A	
VALVE FLAPPER-oil and gasoline resistant	74154-1	

* Denotes new parts

ALWAYS FURNISH MODEL AND SERIAL NUMBER WHEN ORDERING PARTS.